

Forest Glen Christian Camp



Lakeside

Forest Glen Christian Camp
#34 Forest Glen Huntsville, TX 77340
(936) 295-7641 Fax (936) 295-8479
www.forestglen.org
retreats@forestglen.org

A Short History of Forest Glen

In 1965, an organization known as Child Evangelism Fellowship of Harris Co. began its first session of Camp Good News. They started in a facility leased from the Houston Salesmanship Club near Spring, TX. After about five years of growth, Camp Good News could no longer fit within the time constraints of the Salesmanship Club Camp. A search began for a larger facility, which would allow for growth.

Unable to find a facility near Houston which could be leased, Child Evangelism Fellowship set out to purchase property on which to build its own camp facility. CEF's State Board was unwilling to let the Houston organization undertake such a large project, so a group of men with an organization called Houston Christian Businessmen's Foundation set out to purchase property and develop a site for Camp Good News. Top priority for summer usage would be given to Camp Good News and other Christian organizations and churches could use the facilities throughout the rest of the year. Houston Christian Businessmen's Foundation located the existing property in the spring of 1971. An offer was tendered and the purchase was closed in the fall of that year. At the time, the site had no improvements except a clearing for the lake and poorly constructed dam.

A call was put out for funding and volunteers and slowly the site began to take shape. The dam was repaired, the shores of a lake were formed and an island was built. A storage barn was built on site to hold beds, kitchen equipment and other supplies as they were donated or received from surplus auctions. Trees were cut down and sent to be milled into rough sawn boards and logs suitable for trusses. The new camp was called Forest Glen.

The summer of 1974 brought the first summer camping programs to Forest Glen. Facilities were rustic to say the least. The dining hall (Lodge) was only a roof. A diesel generator provided electricity and port-a-potties worked for outdoor plumbing. Campers slept in army squad tents and the showers consisted of a plywood screen around a tree that had a couple of pipes running up its sides. The campers loved it!

As volunteers worked and donations were received, the facilities began to take shape. By 1976 the dining hall and one cabin cluster were completed. The end of 1977 added a second cluster of cabins and a sewer plant. And in 1980 a staff house and the swimming pool were in place. By 1984 Forest Glen was a nice facility serving up to 160 campers at a time for Camp Good News, church camps, and weekend retreats.

Forest Glen's first family camp was started during the Thanksgiving holiday of 1984. In 1987 the first Forest Glen Outdoor Education Experience was held. Forest Glen was beginning to create camping programs designed to meet specific needs. Forest Glen day camp began in 1989 and in 1991 programming was put into place to serve inner city youth.

Facilities had to keep pace with increasing program needs. By 1994 the new dining hall was complete except for the kitchen. The third cabin cluster was finished, and staff had moved offices into the present office/ meeting center. Forest Glen had grown to a capacity of 254 beds and was serving 17,400 camper days per year. The following year the old dining hall was remodeled to become the Lodge and food service facilities were completed on the new dining hall.

1996 to 2004 was a period of explosive growth for Forest Glen. During that time the Lord provided funding to build Lakeside Retreat, a full service facility to serve 300 campers. Mid-week programs to serve public and private schools were begun and other programs grew. In September of 2004 the Forest Glen Springs facility near Rosebud, Texas, was purchased. This added 200 beds to Forest Glen's ministry capacity, bringing the total to 750 campers. We are now busy renovating the Springs camp and replacing our oldest cabins at our Huntsville campus.

Today Forest Glen stands as a testimony to God's faithfulness and to all who have had a part in its development. This year we will serve 20,000 campers at 3 beautiful campuses. Each camper will be served by caring staff members who work to assure that **lives are changed at camp.**

Forest Glen Christian Camp - Statement of Faith

All groups who utilize the facilities of Forest Glen under their own programming shall be in agreement with the following Statement of Faith:

1. The Scriptures of the Old and New Testaments are verbally inspired by God, and are inerrant in the original writings, and are the supreme and final authority in faith and life.
2. There is one God, eternally existing in three persons, the Father, the Son (Jesus Christ) and the Holy Spirit.
3. Jesus Christ was begotten by the Holy Spirit, born of the Virgin Mary, and is true God and true man.
4. Man was created in the image of God, he sinned, and thereby incurred not only physical death but also spiritual death, which is separation from God; all human beings are born with a sinful nature.
5. Jesus Christ died for all our sins, according to the Scriptures, as a representative and substitutionary sacrifice; all who believe in Him are justified on the ground of His shed blood.
6. Jesus Christ rose from the dead in His physical body, ascended into Heaven, and is in His present life there for us our High Priest and Advocate.
7. Jesus Christ will personally return to earth in like manner as He ascended into Heaven and set up His kingdom wherein He will rule and reign in righteousness.
8. All who receive by faith, the Lord Jesus Christ are born again of the Holy Spirit, and thereby become the children of God.
9. There shall come the bodily resurrection of the just and the unjust which shall result in the blessedness of the saved and the retribution of the lost.

It is essential that the group teaches the Gospel of Jesus Christ in order that their time at camp be used to further the spiritual purpose of Forest Glen.

Forest Glen Camps

Retreat Policies

Group Leader: Please make a copy of these policies available to each member of your group!

Arrival:

- ☹ Check in with a host in the office upon arrival.
- ☹ At check in, report to the host the number of people who are in your group at each meal. This number should include everyone in your group. (Leaders, campers, children, etc.)
- ☹ Payment is due upon arrival.
- ☹ *Summer Groups staying 3 nights or more must complete Child Abuse Prevention Training before arrival.*

Parking:

- ☹ After unloading, all vehicles are to be parked in designated parking areas.
- ☹ Do not block roadways or entrances.

Bedding:

- ☹ Campers must furnish their own bedding and toiletries.

Leadership:

- ☹ Sponsors must maintain supervision of all members of their group.
- ☹ There is a suggested minimum camper to chaperone ratio of 10:1 for teenagers and 8:1 for children.
- ☹ Chaperones need to be at least 18 years of age and two years older than campers.

Meals:

- ☹ Meals will be served promptly at the following times:

Breakfast – 8:00 am

Lunch – 12:30 pm

Supper – 6:00 pm

- ☹ After meals, have campers take dishes to the washing area, scrape and stack neatly. Tables need to be wiped down with chairs pushed in.
- ☹ No glasses, dishes, silverware, etc., are to be removed from the dining hall.

Activities:

- ☹ Guidelines for activity use are posted at each activity and must be followed.
- ☹ All activities must be scheduled in advance. Ropes course, rifles and paintball require an additional fee.
- ☹ No one is allowed at any activity areas (archery, BBs, rifles, ropes course, etc.) without Forest Glen staff.
- ☹ All other activities need to be supervised by a group chaperone.

Waterfront/Swimming:

- ☹ No one is allowed at pool/waterfront activity areas except during scheduled times when the lifeguard is on duty.
- ☹ Two piece swimsuits may be worn only if they are covered by a non-see through T-shirt.
- ☹ No midriff showing is allowed.
- ☹ Life jackets must be worn at all times for Blobbing and canoeing.
- ☹ A group chaperone should be present at the waterfront when the group is fishing.
- ☹ Forest Glen will provide adequate personnel who hold current American Red Cross Lifeguard Training or equivalent certification to guard each waterfront / swimming activity during the scheduled times for these activities.
- ☹ Waterfront activities are available for scheduling on Saturdays (swimming and Blobbing 1st weekend in May through 1st weekend in Oct).
- ☹ Waterfront activities are available for scheduling on Sunday afternoons *only in the summer.*

First Aid:

- ☹ The group shall be responsible for first aid and emergency care, medical supplies, emergency transportation, and providing an adult who is certified in American Red Cross Standard First Aid and CPR or the equivalent.
- ☹ Any group consisting of minors is responsible for completing a form with the following information for all minors: a roster of names, emergency contact information, consent to treat a minor, and emergency medical release form.

Miscellaneous:

- ☹ Use of firearms and fireworks is prohibited unless prior arrangements have been made.
- ☹ When not in use, all firearms must be locked in vehicles.
- ☹ Only God can make a tree, so none are to be defaced or chopped down.
- ☹ All profanity, immoral conduct of any nature, and immodest dress are forbidden.
- ☹ No alcoholic beverages or illegal drugs shall be permitted on the premises, nor shall anyone who is under the influence of either.
- ☹ For the safety and peace of all campers, pets are not permitted at Forest Glen.
- ☹ Motorized bikes may be used only to make initial entry and final exit from camp and must remain in the road. Motorized bikes are not allowed off road at any time.
- ☹ Because of the fire hazard, campfires are only permitted at Forest Glen during scheduled times and in places designated by Forest Glen staff.
- ☹ Because of the fire hazard, smoking is only permitted in parking lots or on paved areas.
- ☹ Males and females may not visit each other's cabins and there is to be no raiding of cabins.

Forest Glen Christian Camp
Lakeside Retreat Pricing

	Cost per Person		
Nights	Number of Meals		
1	2 - \$43	3 - \$49	4 - \$55
2	4 - \$86	5 - \$92	6 - \$98
3	8 - \$138	9 - \$144	10 - \$150
4	11 - \$182	12 - \$188	13 - \$194
5	14 - \$224	15 - \$230	16 - \$236

To add/subtract a meal add/subtract \$6 /meal

Camp Activities for Northshore and Lakeside

Huntsville, TX

VOLLEYBALL
FISHING
BASKETBALL
SOCCER
HIKING

The following activities need to be scheduled with the retreat director at least two weeks prior to the retreat and are subject to availability:

CANOEING
ARCHERY
BB GUNS
SWIMMING & THE BLOB (seasonal)

Ropes Course:

With overnight retreat: \$15/person for Low Ropes OR High Ropes
\$25/person for BOTH
One day event: \$35/person (includes Lows, Highs and lunch)
Half day event: \$25/person (includes Lows OR Highs and lunch)

Paintball:

\$50 for one hour (includes Forest Glen facilitator, equipment, and 1000 paintballs)

Horse Rides:

Horse rides are scheduled through Lake Raven Stables. The stables are located at Huntsville State Park, about $\frac{1}{2}$ an hour from Forest Glen. If your group has 30 or more riders, the stable will come to Forest Glen. Remember that YOU need to set an appointment with the Lake Raven Stables ahead of time to make sure that there is availability for your group.

To check availability

Call Lake Raven Stables at 936 295 1985 or 936 577 6404

Camp Fires:

Campfires are available to every group. Each group has at least 1 hour at the campfire depending on the availability. To schedule a campfire you must set a time with the retreat staff to make sure of available times. The campfires are at no extra cost.



Forest Glen Camps

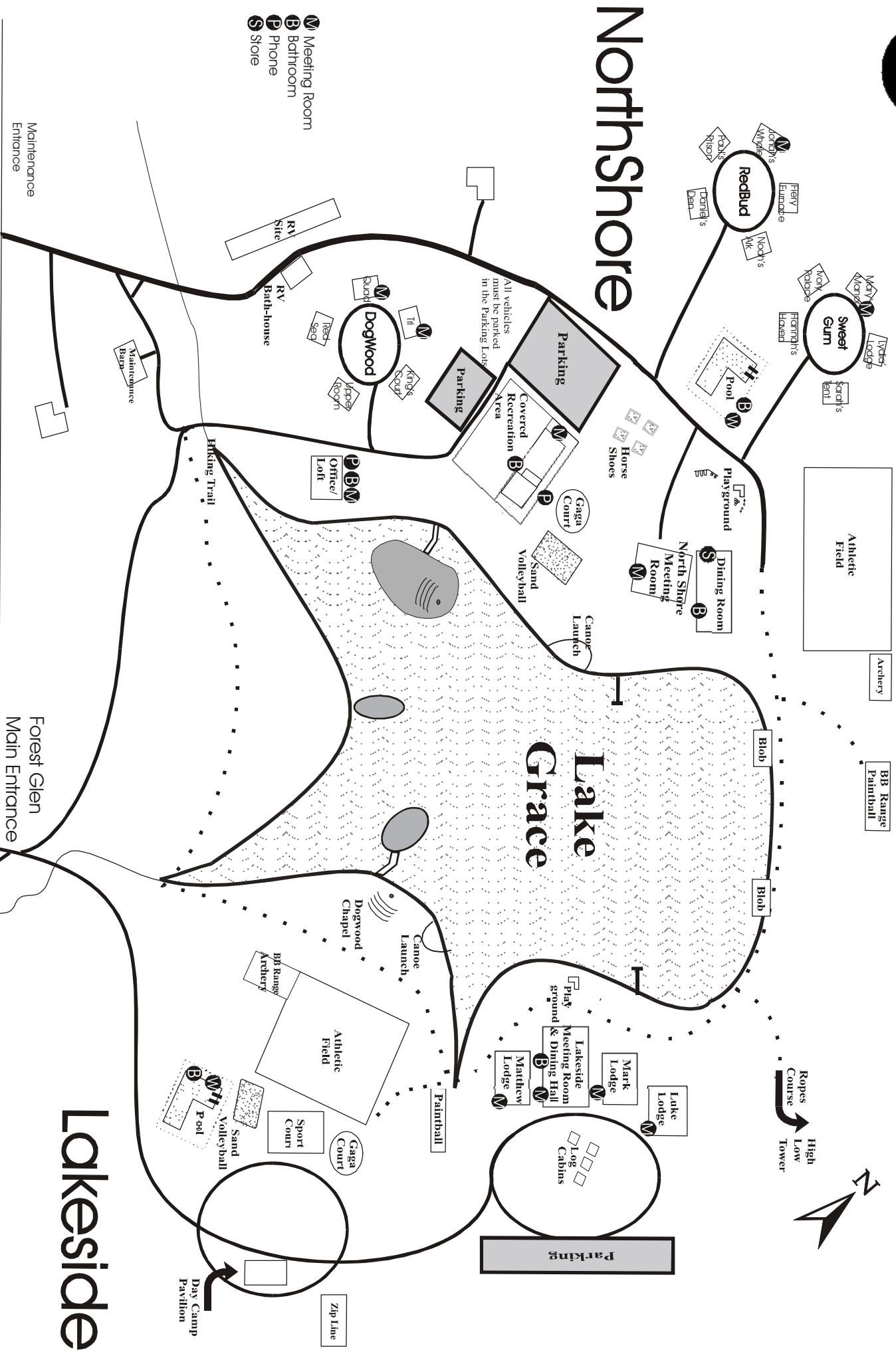

Northshore

Lake Grace

Lakeside

Forest Service Rd. #207

Maintenance Entrance

Forest Glen Main Entrance

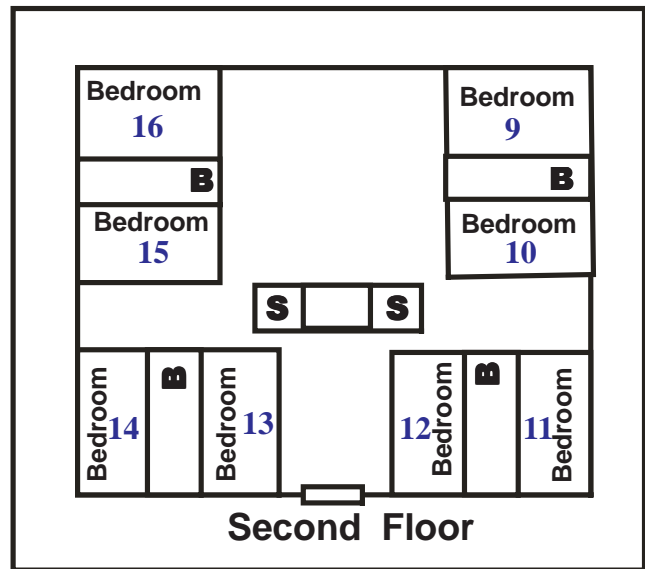
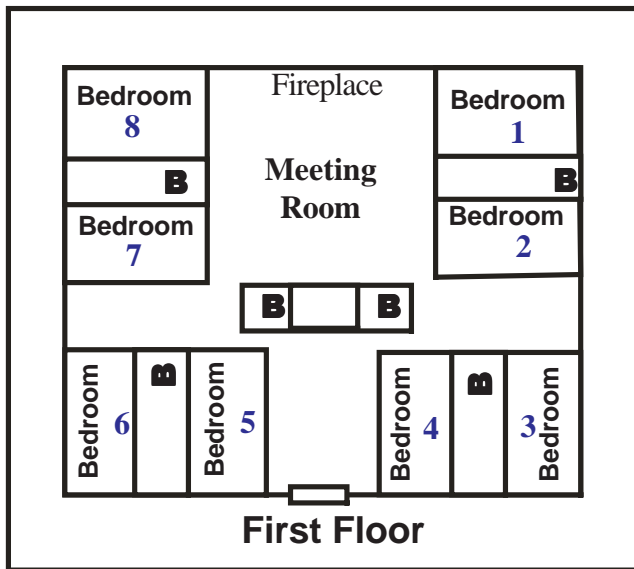

Matthew and Mark Lodges

There are 8 suites in each lodge, with each suite having 2 rooms that have 2 bunk beds in each room. There are 64 total beds in each lodge. Summer months have increased capacity. The meeting room holds 80 comfortably. To reserve the Matthew, Mark or Luke Lodge, you must have a guaranteed minimum of 50 people. Please see the sample contract for cancellation policy of your minimum.

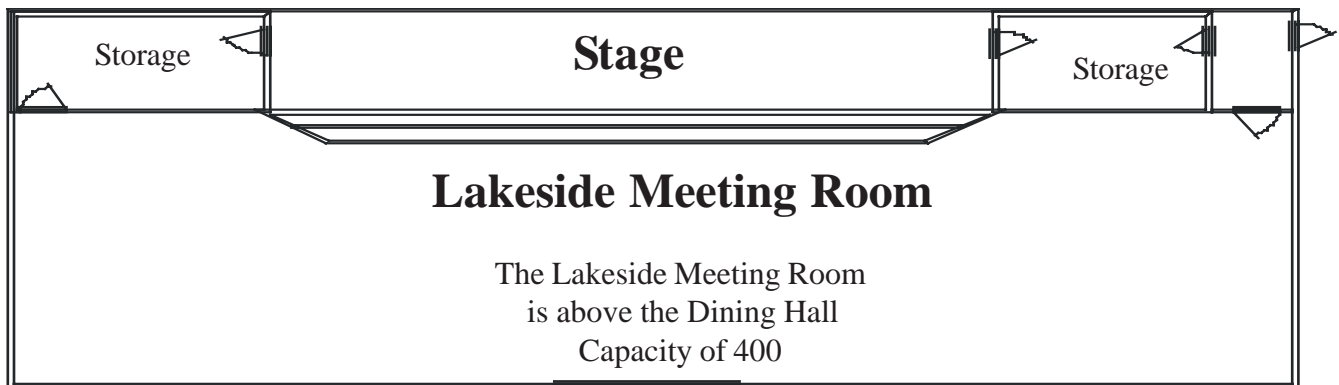

note: drawings are not to scale or in accurate proportion

The Luke Lodge

The Luke Lodge consists of 8 rooms, each with 16 beds and one bathroom (2 toilets, 2 showers). The lodge has a capacity of 128 and contains an adjoining meeting room.

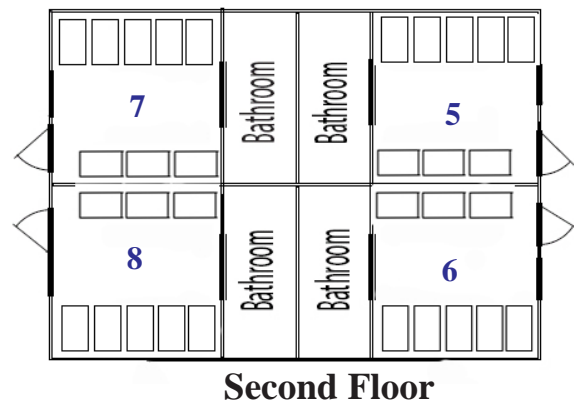
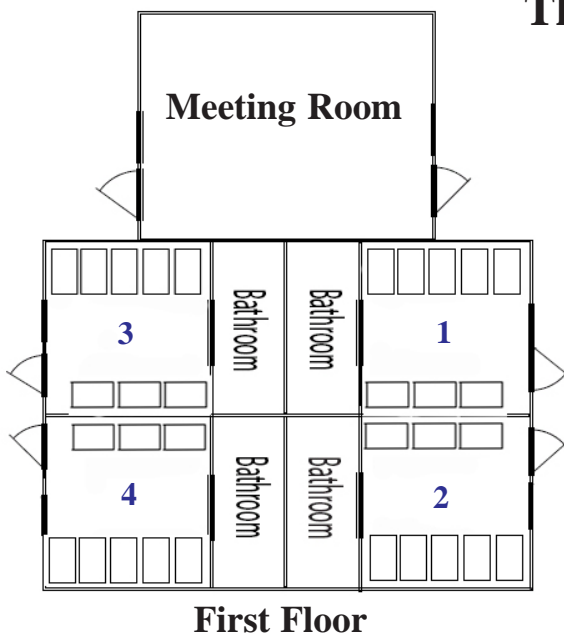

How To Get To Forest Glen

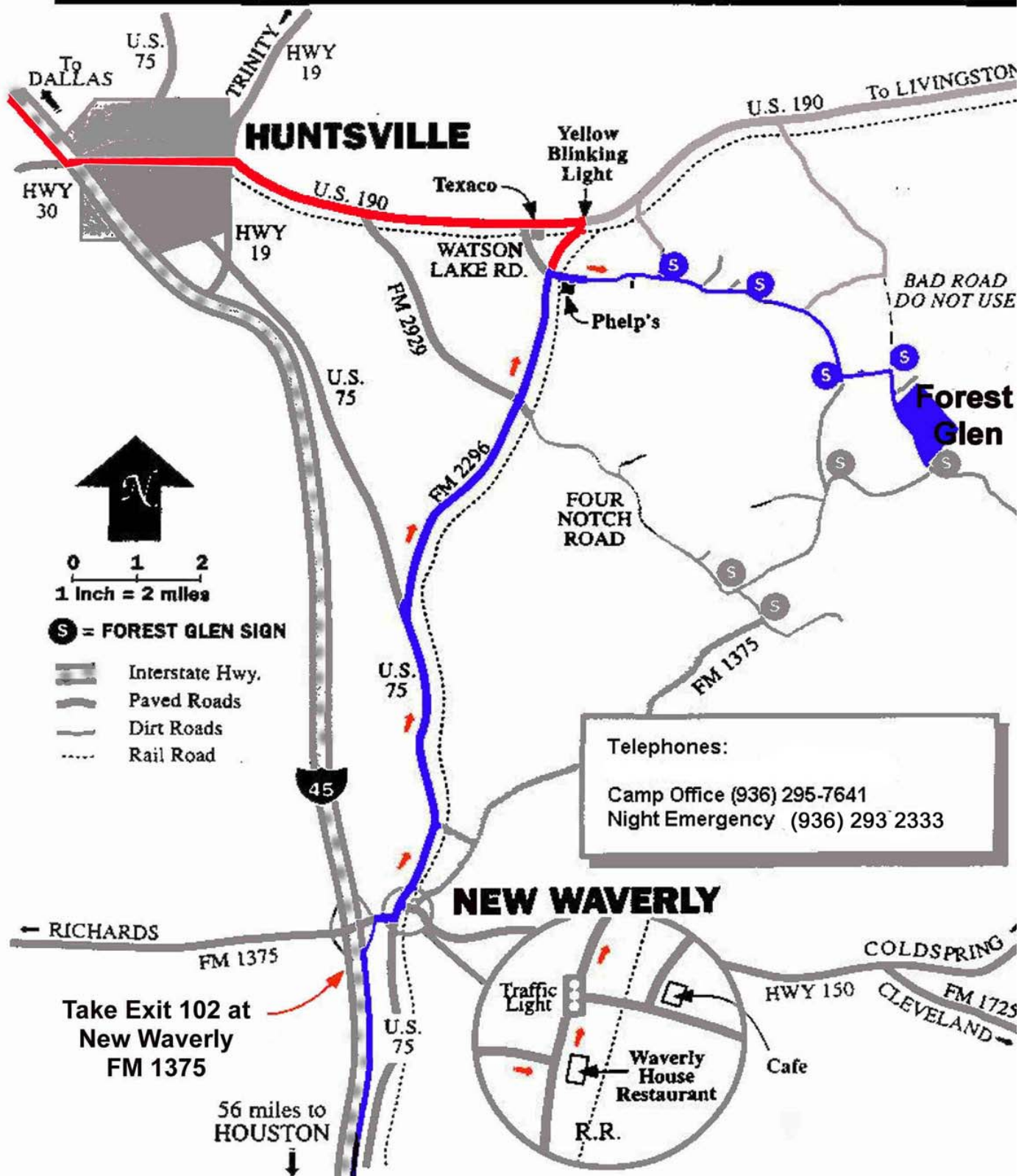

Directions to Forest Glen from Houston

Proceed North on either I-45 or the Hardy Toll Road.
(The Hardy Toll Road merges with I-45 just South of the Woodlands;
during the Friday afternoon rush the toll road will save you approx. 45 minutes.)
Continue North on I-45 to the exit for New Waverly (Exit #102).
Take the exit.
At the stop sign turn Right (East) onto FM 1375.
Proceed approx. $\frac{3}{4}$ mile to the stop sign. Turn Left (North) onto US75
Proceed on US 75 for approx. 5 miles.
Turn Right onto FM 2296.
Proceed for approx. 7 miles.
Turn Right onto Spur 2296 (also known as Watson Lake Road).
As you cross the multiple railroad tracks,
note the big **BLUE** Forest Glen sign on the building on the Left.
(**Do not turn right** immediately after crossing the railroad tracks).
Stay on this road for 6.5 miles. Follow the blue Forest Glen signs.
The pavement will end after about 2 miles.
From this point on you will be in the Sam Houston National Forest.
The roads will be all dirt and gravel.
There are **BLUE FOREST GLEN** signs at each intersection to direct you.

Directions to Forest Glen from Dallas

Proceed South on I-45 to Huntsville; take Exit #116.
Go to the signal light and turn LEFT onto Hwy 190 EAST.
Proceed on Hwy 190 East for 8.2 miles to the caution light.
(You will travel through town; always stay on Hwy 190 East;
the road will narrow into two lanes as you enter the rural area.)
At the caution light turn RIGHT onto FM 2296.
Proceed on FM 2296 for 0.7 mile.
You will crossover a single railroad track.
At the intersection turn LEFT onto Spur 2296, also known as Watson Lake Road.
As you cross the multiple railroad tracks,
note the big **BLUE** Forest Glen sign on the building on the Left.
(**Do not turn right** immediately after crossing the railroad tracks.)
Stay on this road for 6.5 miles. Follow the blue Forest Glen signs.
The pavement will end after about 2 miles.
From this point on you will be in the Sam Houston National Forest.
The roads will be all dirt and gravel.
There are **BLUE FOREST GLEN** signs at each intersection to direct you.